

INTERSEÇÃO 01 (RODOVIA SC-416)

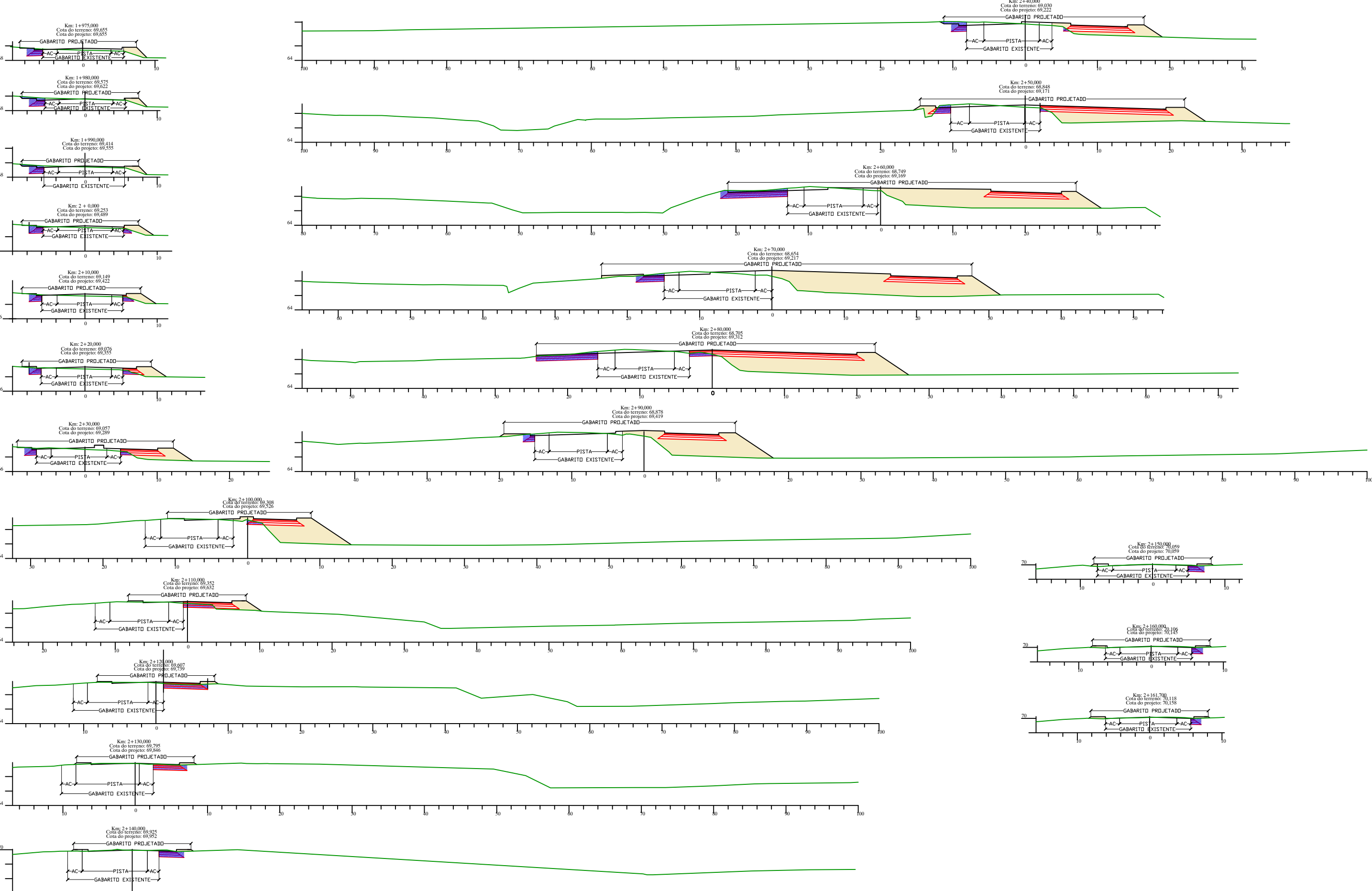

INTERSEÇÃO 02 (RODOVIA SC-416)

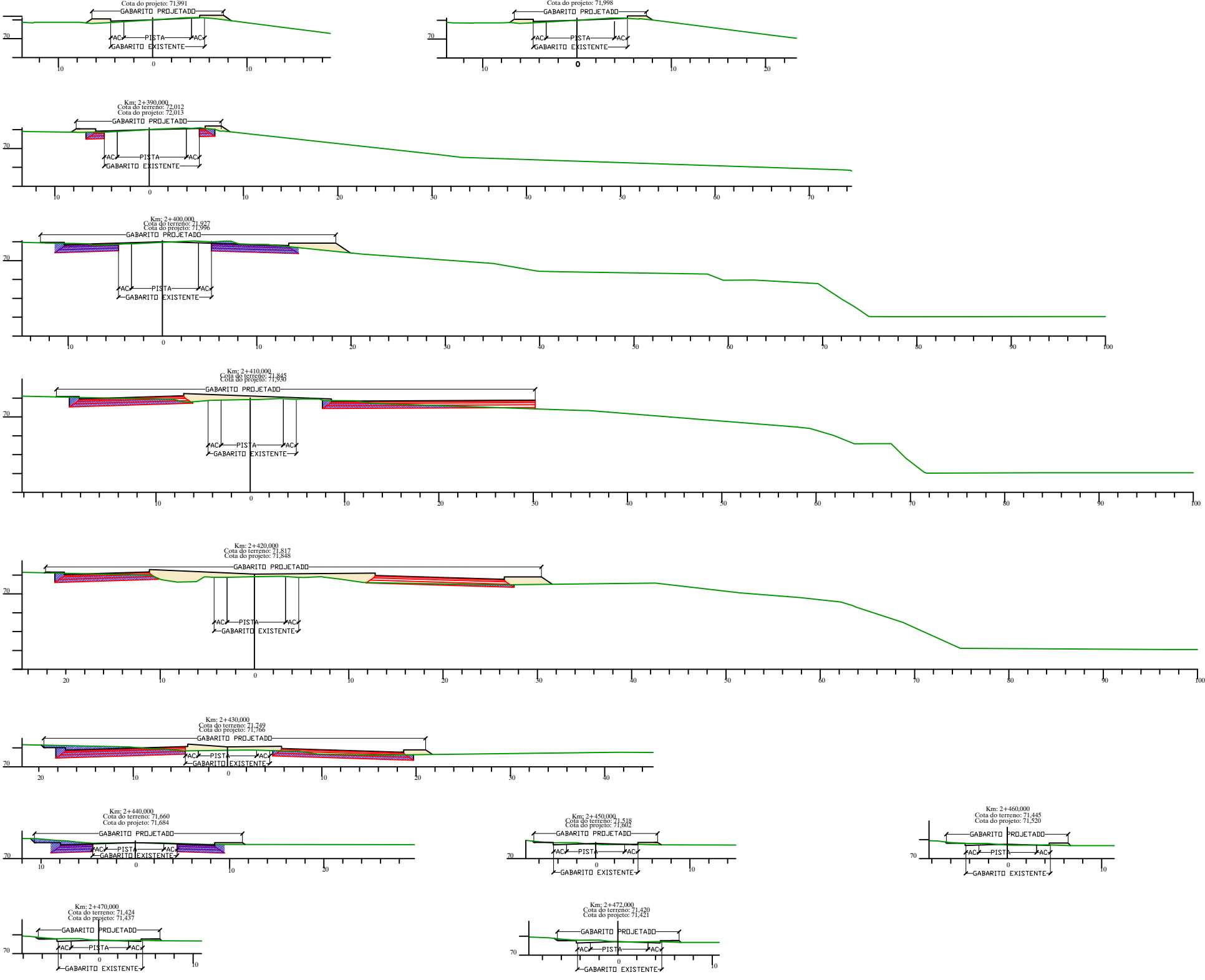

INTERSEÇÃO 03 (RODOVIA SC-477)

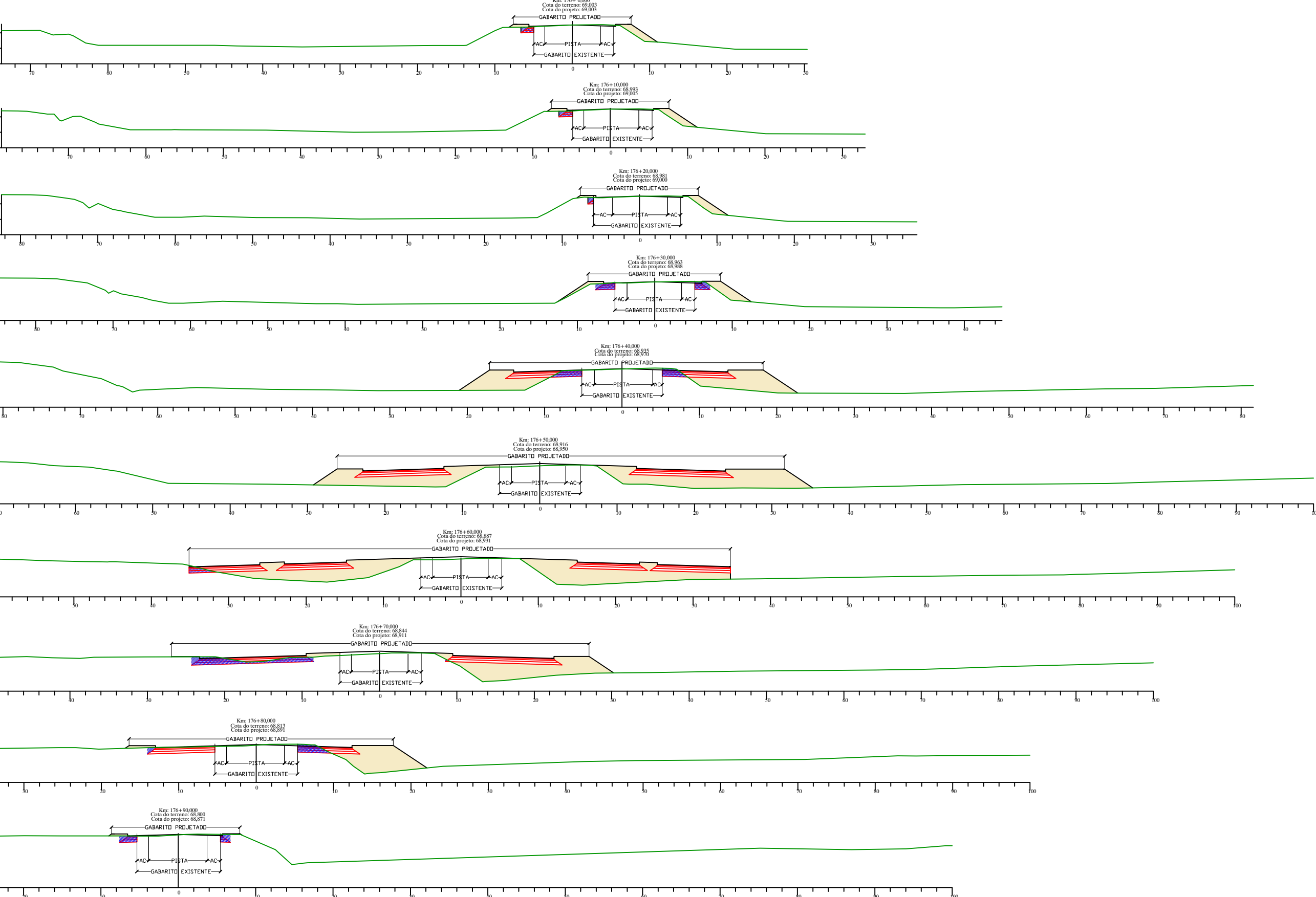

VIAS DE ACESSO A PONTE

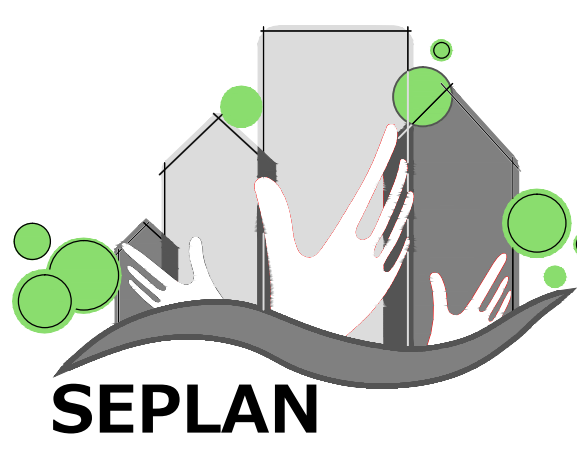
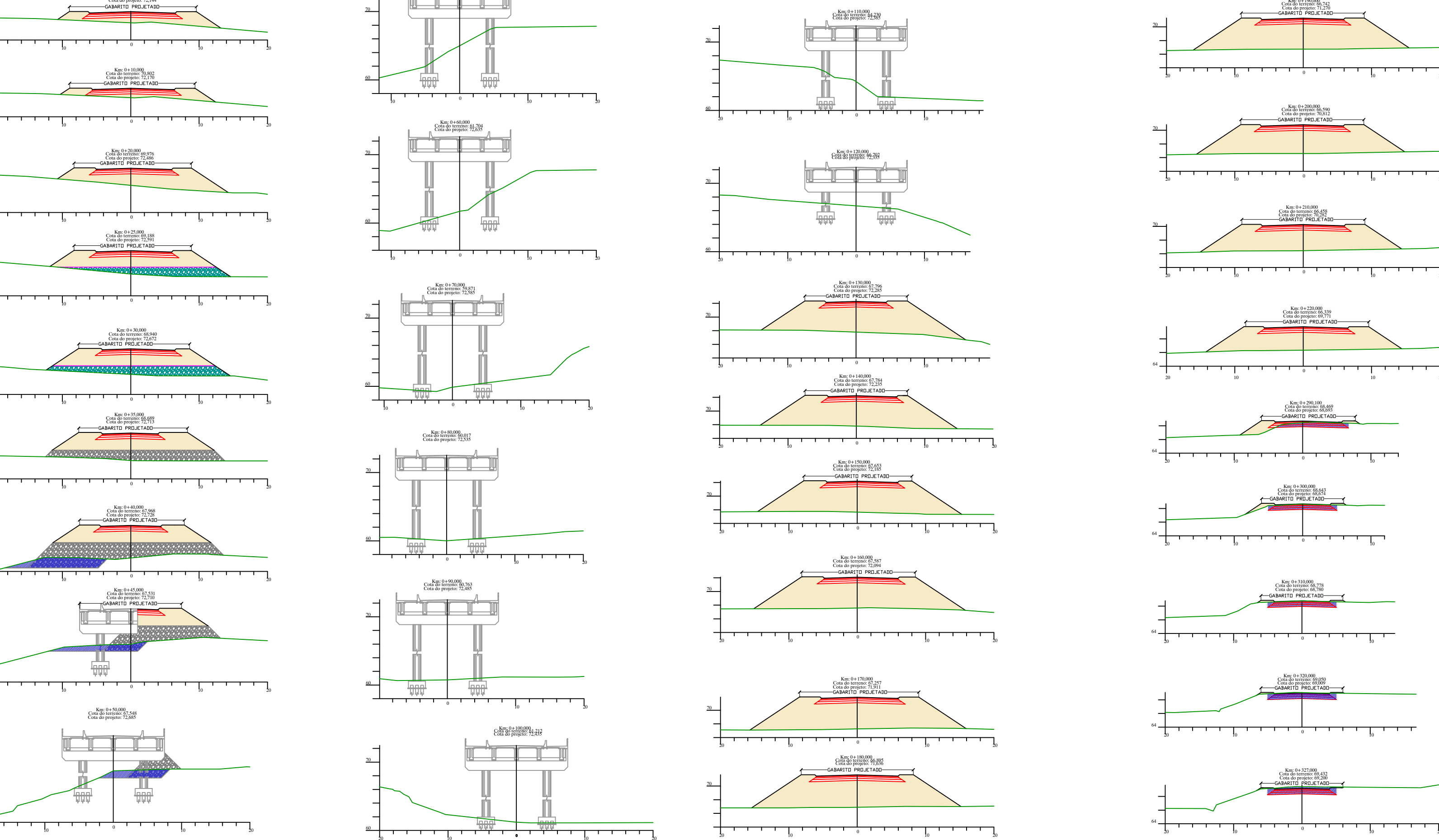

**PREFEITURA
DE TIMBÓ**

**SECRETARIA MUNICIPAL
DE PLANEJAMENTO**

Obra: Projeto Pavimentação Asfáltica ROTÁTORIAS E ACESSOS À PONTE			
Endereço:			
Projeto: PERFIS TRANSVERSAIS			
Resp. Técnico Projeto:			
Data: FEV./2018	Escala: 1 / 500	Área:	Prancha: P.TR. 01